

CATEGORY	DESCRIPTION	P/N #
CONNECTOR	RJ45 TYPE	MJ880R-11060-0010

REV.	ECN NO	DESCRIPTION	REVISED	DATE
A1		新訂圖面	JXM	2009.03.02

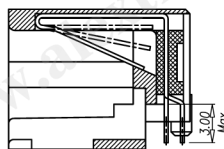

SECTION A-A  
SCALE 1:1

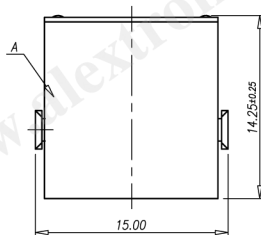
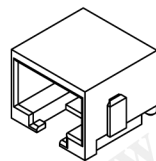

SPECIFICATIONS:

1: RJ Electrical Characteristics

- 1-1: Voltage: 150V AC RMS
- 1-2: Current Rating: 1.5A
- 1-3: Contact Resistance: 30m\* MAX.
- 1-4: Insulation Resistance: 500M\* MIN.
- 1-5: Dielectric Withstang Voltage :1000V AC
- 1-6: .OPERATING TEMPERATURE: -40°C~+80°C
- 1-7: Durability: 500 Mating Cycles MIN.

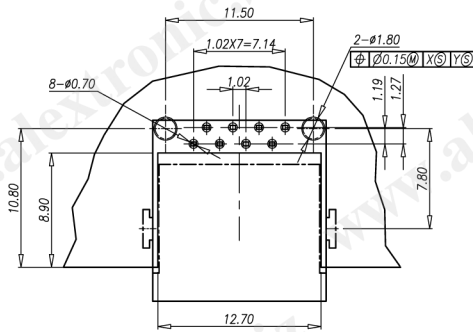
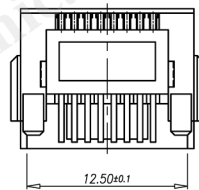
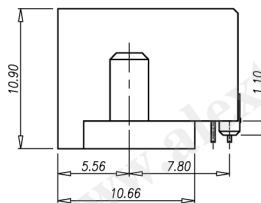
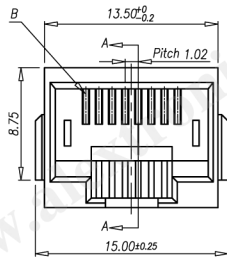

Recommend PCB Hole Layout  
(Jack Top View)  
Tolerance: ±0.05mm  
Recommend PCB Thickness: 1.6mm

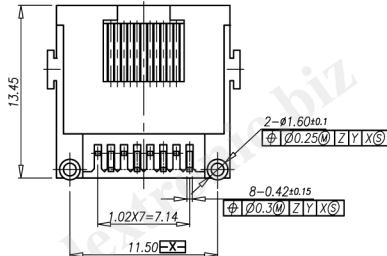

PROOPSAL ONLY

B	TERMINAL	8	T: Phosphor Bronze, T=0.3mm, 6u" Min Gold plated In Contact Area, 80u" Min, Tin Plated In Solder Area, 50u" Min Nickel Underplated Overall. H: PBT UL94V-0, Color: Black.		
A	HOUSING	1	PBT UL94V-0	BLACK	
NO.	PART NAME	Q'TY	MATERIAL	PLATING & COLOR	Remark

UNLESS OTHERWISE SPECIFIED TOLERANCES	SCALE: 1/1	UNIT: mm	⊕ ⊖	DWG. NO:	
	SIZE: A3	PAGE: 1 OF 1	REV: A1		
DECIMALS:	X : ±0.5	ANGLES:	X : ±2°	APPROVED BY	
	X.X : ±0.3		X.X : ±1°	WYX	
	X.XX : ±0.2			CHECKED BY	
				Pengjie	
				PREPARED BY	
				JXM	
				CUSTOMER COPY	